

RECESS FORMER

Magnetic Recess Formers

This steel body is turned from solid material and fitted with a high-performance magnetic system, providing a high-powered magnet for locating anchors in steel forms.

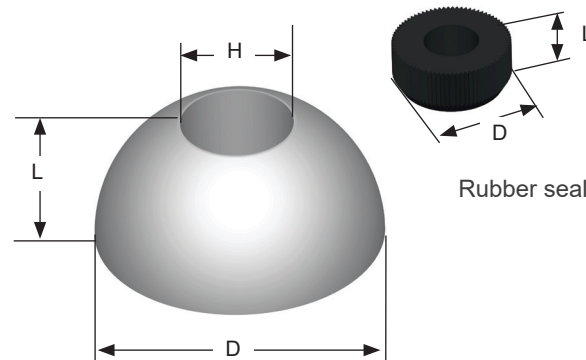

ITEM CODE	SYSTEM CODE	RECESS DIAMETER (D)	RECESS HEIGHT (L)	HOLE DIAMETER (H)	THREAD
LH13M	1.3	2-3/8"	1-1/8"	13/16"	
LH25M	2.5	2-7/8"	1-5/16"	1-1/8"	M12
LH50M	5	3-11/16"	1-5/8"	1-1/2"	M12
LH75M	10	4-3/4"	2-1/8"	1-7/8"	M12
			HEIGHT (L)	DIAMETER (D)	
LH13GM	Rubber Seal For Magnet		7/16"	13/16"	
LH25GM	Rubber Seal For Magnet		1/2"	1-3/16"	
LH50GM	Rubber Seal For Magnet		9/16"	1-1/2"	
LH75GM	Rubber Seal For Magnet		3-4"	1-15/16"	

Rubber Recess Formers

Used to recess the anchors relative to the concrete surface. Each Rubber Recess Former requires one Wing Nut, Plate, and Stud Set to attach it to the form.

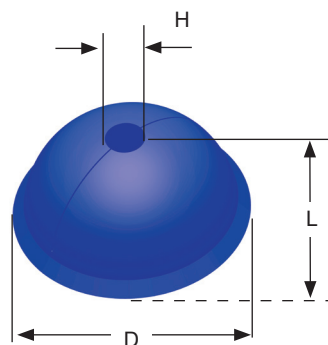

ITEM CODE	SYSTEM CODE	RECESS DIAMETER (D)	RECESS HEIGHT (L)	HOLE DIA. (H)
RR01	1.3	2-5/16"	1-3/16"	3/8"
RR02	2.5	2-7/8"	1-7/16"	9/16"
RR04	5	3-11/16"	1-7/8"	3/4"
RR08	10	4-5/8"	2-5/16"	1-1/8"
RR16	20	6-1/2"	3"	1-1/2"

Steel Recess Former

Drilled and tapped to allow bolting directly to the form.

Can be welded to certain types of forms where location is permanent.

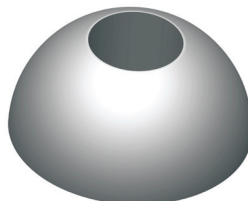

ITEM CODE	SYSTEM CODE	RECESS DIAM. X DEPTH
RS01	1.3	2-5/16" X 1-3/16"